



MTN/1020 Series

Low cost, general purpose industrial accelerometer

Applications

- Paper machinery
- General industry
- Pumps, fans, etc.
- Air handling units
- Machine tools

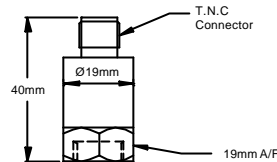

Technical Specification

Standard Sensitivity	100 mV/g $\pm 10\%$ Nominal at 80 Hz
Frequency Response	2 Hz to 13 kHz $\pm 5\%$ (-3 dB at 0.8Hz)
Mounted Base Resonance	18 kHz (nominal)
Isolation	Base non-isolated
Dynamic Range	± 80 g
Transverse Sensitivity	Less than 5%
Electrical Noise	0.1 mg max
Current Range	0.5 mA to 8 mA
Temperature Range	-25 to 120 °C
Temperature Sensitivity	0.08 %/°C
Bias Voltage	12 Volts DC (nominal)
Case Material	Stainless steel
Mounting Torque	8 Nm
Weight	52 gms (nominal)
Sealing	IP67
Connector	T.N.C.
Options	50 mV/g sensitivity, mating cable assemblies.

ORDER CODE PART No	MOUNTING
MTN/1020-xx MTN/1020Q-xx	¼ UNF FEMALE QUICK FIT FEMALE
FOR OTHER MOUNTINGS SEE OVER PAGE	

Mounting Adapters and Studs

Studs and Grub Screws



Male Studs		
Product Code	From	To
MS036	1/4" - 28 UNF	M6
MS039	1/4" - 28 UNF	10 - 32 UNF
MS067	1/4" - 28 UNF	M8
MS068	1/4" - 28 UNF	1/4" - 28 UNF
MS124	1/4" - 28 UNF	M10
MS132	1/4" - 28 UNF	M12

Quick Fit Adapters

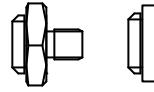

1120 Quick Fit (Q/F)		
Product Code	From	To
MS010	1120 Q/F Male	Glue Base
MS055	1120 Q/F Male	M8 Male
MS072	1120 Q/F Male	M6 Male
MS102	1120 Q/F Female	10 - 32 UNF Male
MS117	1120 Q/F Male	1/4" - 28 UNF Male

1120 Studs		
Product Code	From	To
MS021	1/4" - 28 UNF	M8

Other Adapters

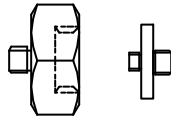

Mounting Adapters		
Product Code	From	To
MS011	1/4" - 28 UNF Male	Q/F Female
MS013	1/4" - 28 UNF Male	Glue Base
MS033	1/4" - 28 UNF Male	Q/F Female
MS061	1/4" - 28 UNF Male	10 - 32 UNF Male
MS079	1/4" - 28 UNF Male	Q/F Female

Isolation		
Product Code	From	To
MS034	1/4" - 28 UNF Male	1/4" - 28 UNF Female
MS027	M6 Male	M6 Female

System Connection

