



MTN/1100W Series

Fully submersible industrial accelerometer

Applications

- Submersible pumps
- Roll monitors
- Paper machinery

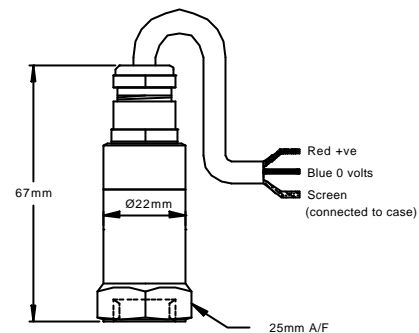

Technical Specification

Standard Sensitivity	100mV/g \pm 10% nominal at 80Hz
Frequency Response	2 Hz to 10 kHz \pm 5% (-3dB at 0.8Hz)
Measurement Range	\pm 50 g
Mounted Resonance	18 kHz min
Isolation	Base isolated
Operating Temp Range	-25 to 90 °C
Electrical Noise	0.1 mg max
Current Range	0.5 mA to 8 mA
Transverse Sensitivity	Less than 5%
Bias Voltage	12 Volts DC (nominal)
Cable	Polyurethane – length to be specified at point of order
Maximum Cable	1000 metres
Case Material	Stainless steel
Weight	120 gms (nominal)
Sealing	IP68
Mounting Torque	8 Nm
Submersible Depth	100 metres maximum (10 bar)

ORDER CODE PART No	MOUNTING
MTN/1100W MTN/1100QW	½ UNF FEMALE QUICK FIT FEMALE
FOR OTHER MOUNTINGS SEE OVER PAGE.	

Mounting Adapters and Studs

Studs and Grub Screws



Male Studs		
Product Code	From	To
MS036	1/4" - 28 UNF	M6
MS039	1/4" - 28 UNF	10 - 32 UNF
MS067	1/4" - 28 UNF	M8
MS068	1/4" - 28 UNF	1/4" - 28 UNF
MS124	1/4" - 28 UNF	M10
MS132	1/4" - 28 UNF	M12

Quick Fit Adapters

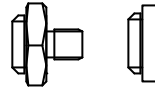

Quick Fit (Q/F)		
Product Code	From	To
MS001	Q/F Male	Glue base
MS002	Q/F Male	M8 Male
MS003	Q/F Male	M10 Male
MS004	Q/F Male	1/4" - 28 UNF Male
MS006	Q/F Male	M6 Male

Other Adapters

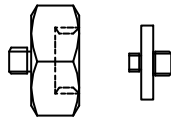

Mounting Adapters		
Product Code	From	To
MS005	Q/F Male	1/4" - 28 UNF Female
MS007	Q/F Male	10 - 32 UNF Female
MS008	Q/F Male	M8 Female
MS011	1/4" - 28 UNF Male	Q/F Female
MS013	1/4" - 28 UNF Male	Glue base
MS033	1/4" - 28 UNF Male	Q/F Female
MS038	Q/F Male	M8 Conical Male
MS061	1/4" - 28 UNF Male	10 - 32 UNF Male
MS079	1/4" - 28 UNF Male	Q/F Female
MS106	Q/F Male	M10 Female

Isolation		
Product Code	From	To
MS034	1/4" - 28 UNF Male	1/4" - 28 UNF Female
MS093	Q/F Male	M8 Male

System Connection

