



## MTN/1100I & M1100I Series

Intrinsically safe industrial accelerometer  
Atex Group I & II approved

### Applications

- Intrinsically safe data-collector
- Oil & mining
- Fans, compressors, pumps, etc.

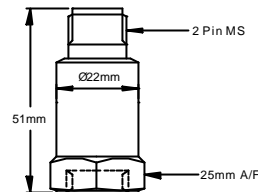

### Technical Specification

Standard Sensitivity	100 mV/g $\pm 10\%$ nominal at 80 Hz
Frequency Response	2 Hz to 10kHz $\pm 5\%$ (-3 dB at 0.8 Hz)
Mounted Base Resonance	18 kHz (nominal)
Isolation	Base isolated
Transverse Sensitivity	Less than 5%
Electrical Noise	0.3 mg max
Current Range	0.5 mA to 8 mA
Bias Voltage	12 Volts DC (nominal)
Case Material	Stainless steel
Temperature Range	-55 to 140 °C
Weight	110 gms (nominal)
Sealing	IP67
Maximum Cable Length	See system drawing ATX011
Certificate Details: Group I	EEx ia I, Baseefa02ATEX0245
Group II	EEx ia IIC T6, BAS02ATEX1057
System Connection	Drawing ATX011
Barrier	1 x MTL 728, BAS01ATEX7202 or P & F Z728 BAS01ATEX7005 or any other barrier that conforms to Note 4 of ATX011.
Options	Mating connectors, MH002 (Standard), MH088 (Stainless steel), other sensitivities (see table)

ORDER CODE PART No	MOUNTING	xx =OPTIONAL SENSITIVITY RANGE AVAILABLE (+/- 10%)
MTN/1100I-xx MTN/1100IQ-xx	½ UNF FEMALE QUICK FIT FEMALE	10 mV/g 30 mV/g 50 mV/g
FOR OTHER MOUNTINGS SEE OVER PAGE.		

# Mounting Adapters and Studs

## Studs and Grub Screws



Male Studs		
Product Code	From	To
MS036	1/4" - 28 UNF	M6
MS039	1/4" - 28 UNF	10 - 32 UNF
MS067	1/4" - 28 UNF	M8
MS068	1/4" - 28 UNF	1/4" - 28 UNF
MS124	1/4" - 28 UNF	M10
MS132	1/4" - 28 UNF	M12

## Quick Fit Adapters

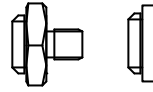

Quick Fit (Q/F)		
Product Code	From	To
MS001	Q/F Male	Glue Base
MS002	Q/F Male	M8 Male
MS003	Q/F Male	M10 Male
MS004	Q/F Male	1/4" - 28 UNF Male
MS006	Q/F Male	M6 Male

## Other Adapters

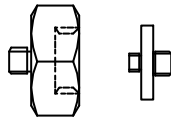

Mounting Adapters		
Product Code	From	To
MS005	Q/F Male	1/4" - 28 UNF Female
MS007	Q/F Male	10 - 32 UNF Female
MS008	Q/F Male	M8 Female
MS011	1/4" - 28 UNF Male	Q/F Female
MS013	1/4" - 28 UNF Male	Glue Base
MS033	1/4" - 28 UNF Male	Q/F Female
MS038	Q/F Male	M8 Conical Male
MS061	1/4" - 28 UNF Male	10 - 32 UNF Male
MS079	1/4" - 28 UNF Male	Q/F Female
MS106	Q/F Male	M10 Female

Isolation		
Product Code	From	To
MS034	1/4" - 28 UNF Male	1/4" - 28 UNF Female
MS093	Q/F Male	M8 Male

## Barrier System Connection

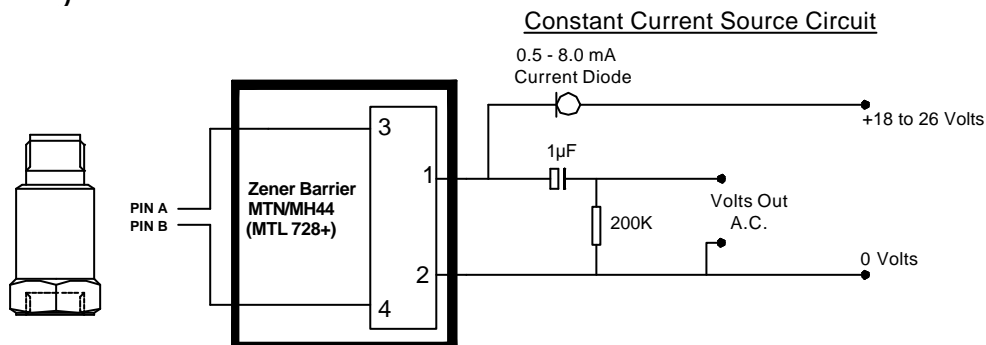

Barrier Enclosures		
Product Code	Type	Capacity
MTN/MH073	MT2	2 Barrier Capacity
MTN/MH062	MT5	2 Barrier Capacity
MTN/MH045	MT12	12 Barrier Capacity
MTN/MH024	MT24	24 Barrier Capacity
MTN/MH032	MT32	32 Barrier Capacity