



## MTN/1105HC Series

Industrial accelerometer (requires charge amplifier)

### Applications

- Paper machinery
- Turbines
- High temperature

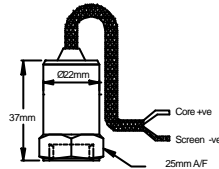

## Technical Specification

### Accelerometer

Sensitivity	50 pC/g (equates to 100 mV/g after charge amplifier)
Capacitance	470 pF nominal
Frequency Response	2 Hz to 10 kHz $\pm 5\%$ (-3 dB at 0.8 Hz)
Mounted Base	18 kHz (nominal)
Isolation	Base isolated
Transverse Sensitivity	Less than 5%
Temperature Range	-55 to 250 °C
Cable	5 metres low noise o/b cable (20 metres maximum between accelerometer & charge amplifier)
Case Material	Stainless steel
Mounting Torque	8 Nm
Weight	100 gms (nominal)
Sealing	IP67
Options	Various mounts, radiation resistant - MTN/1106

### Charge Amplifier

Order MTN/CA003 (connector version) or add an E to order code for integral cable charge amplifier

Bias Voltage	12 Volts DC (nominal)
Noise Floor	1 mg
Dynamic Range	$\pm 50$ g ( $\pm 5$ Volts AC)
Temperature Range	-25 to 125 °C
Input/Output	SMC Connector, BNC or integral cable

ORDER CODE PART No	MOUNTING
MTN/1105C MTN/1105CQ	1/4 UNF FEMALE QUICK FIT FEMALE
FOR OTHER MOUNTINGS SEE OVER PAGE.	

# Mounting Adapters and Studs

## Studs and Grub Screws



Male Studs		
Product Code	From	To
MS036	1/4" - 28 UNF	M6
MS039	1/4" - 28 UNF	10 - 32 UNF
MS067	1/4" - 28 UNF	M8
MS068	1/4" - 28 UNF	1/4" - 28 UNF
MS124	1/4" - 28 UNF	M10
MS132	1/4" - 28 UNF	M12

## Quick Fit Adapters

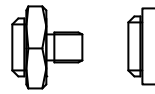

Quick Fit (Q/F)		
Product Code	From	To
MS001	Q/F Male	Glue Base
MS002	Q/F Male	M8 Male
MS003	Q/F Male	M10 Male
MS004	Q/F Male	1/4" - 28UNF Male
MS006	Q/F Male	M6 Male

## Other Adapters

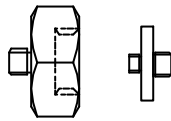

Mounting Adapters		
Product Code	From	To
MS005	Q/F Male	1/4" - 28UNF Female
MS007	Q/F Male	10 - 32UNF Female
MS008	Q/F Male	M8 Female
MS011	1/4" - 28 UNF Male	Q/F Female
MS013	1/4" - 28 UNF Male	Glue Base
MS033	1/4" - 28 UNF Male	Q/F Female
MS038	Q/F Male	M8 Conical Male
MS061	1/4" - 28 UNF Male	10 - 32 UNF Male
MS079	1/4" - 28 UNF Male	Q/F Female
MS106	Q/F Male	M10 Female

Isolation		
Product Code	From	To
MS034	1/4" - 28UNF Male	1/4" - 28 UNF Female
MS093	Q/F Male	M8 Male

# System Connection

