



## MTN/7000 Series

Accelerometer with DC and AC response

### Applications

- Data-collector
- Slow rotating machines
- Test rigs

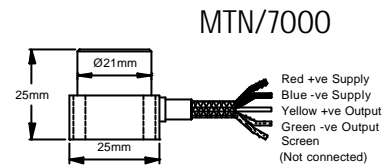

MTN/7010

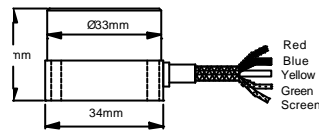

MTN/7020

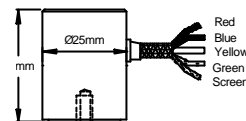

## Technical Specification

Sensitivity	50 mV/g or 100 mV/g (others on request)
Frequency Response	Dependant on dynamic range ( $\pm 5\%$ ) $\pm 1g$ – DC to 250 Hz, $\pm 10g$ – DC to 500 Hz $\pm 2g$ – DC to 250 Hz, $\pm 20g$ – DC to 700 Hz $\pm 5g$ – DC to 300 Hz, $\pm 50g$ – DC to 1 kHz
Resonant Frequency	$\pm 1g$ – 700 Hz, $\pm 10g$ – 850 Hz $\pm 2g$ – 700 Hz, $\pm 20g$ – 1200 Hz $\pm 5g$ – 800 Hz, $\pm 50g$ – 1800 Hz
Isolation	Base isolated
Operation Temp.	-20 °C to +85 °C (extend range available up to 125 °C)
DC Supply	12-24 Volts at 7mA
Output Impedance	50 Ohms
Acceleration Limits	x 20 any direction
Case Material	Stainless steel
Weight	40g nominal
Cable (Standard)	5m of 4 Core stainless steel overbraided PVC
Electrical Noise	10 $\mu$ g

ORDER CODE PART No	MOUNTING	REQUIRES
MTN/7000 MTN/7010	SMALL FOUR POINT LARGE FOUR POINT	4 x M3 BOLTS
MTN/7020 MTN/7020F MTN/7020Q	1/2 UNF SINGLE POINT 10-32UNF SINGLE POINT QUICK FIT SINGLE POINT	SEE OVER PAGE FOR BASE ADAPTERS

# Mounting Adapters and Studs

## Studs and Grub Screws



Male Studs		
Product Code	From	To
MS036	1/4" - 28 UNF	M6
MS039	1/4" - 28 UNF	10 - 32 UNF
MS067	1/4" - 28 UNF	M8
MS068	1/4" - 28 UNF	1/4" - 28 UNF
MS124	1/4" - 28 UNF	M10
MS132	1/4" - 28 UNF	M12

## Quick Fit Adapters

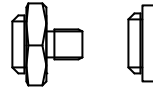

Quick Fit (Q/F)		
Product Code	From	To
MS001	Q/F Male	Glue Base
MS002	Q/F Male	M8 Male
MS003	Q/F Male	M10 Male
MS004	Q/F Male	1/4" - 28 UNF Male
MS006	Q/F Male	M6 Male

## Other Adapters

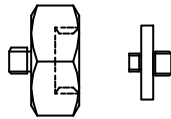

Mounting Adapters		
Product Code	From	To
MS005	Q/F Male	1/4" - 28 UNF Female
MS007	Q/F Male	10 - 32 UNF Female
MS008	Q/F Male	M8 Female
MS011	1/4" - 28 UNF Male	Q/F Female
MS013	1/4" - 28 UNF Male	Glue Base
MS033	1/4" - 28 UNF Male	Q/F Female
MS038	Q/F Male	M8 Conical Male
MS061	1/4" - 28 UNF Male	10 - 32 UNF Male
MS079	1/4" - 28 UNF Male	Q/F Female
MS106	Q/F Male	M10 Female

Isolation		
Product Code	From	To
MS034	1/4" - 28 UNF Male	1/4" - 28 UNF Female
MS093	Q/F Male	M8 Male

## System Connection

**Note:** Circuit is the same for all of MTN/7000 and MTN/7100 series accelerometers.

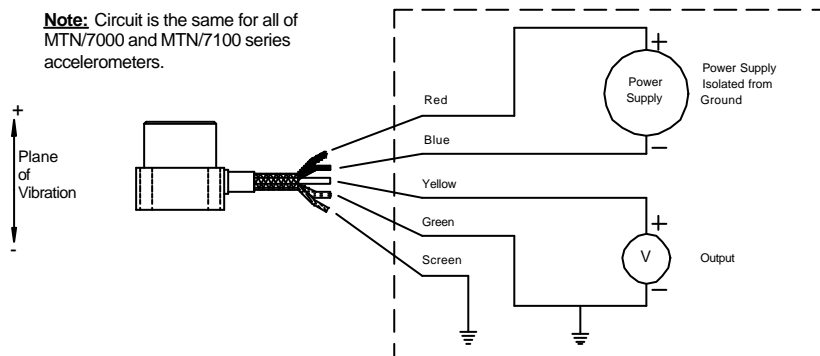

Monitoring System

Note: When mounted horizontally all units will indicate a 1g offset due to gravity